



Report of: **Service Director, Public Protection**

Meeting of	Date	Agenda Item	Ward(s)
Licensing Sub-Committee	14 July 2015		Junction

Delete as appropriate		Non-exempt
-----------------------	--	------------

**Subject: PREMISES LICENCE NEW APPLICATION
ASIAN AND EURO DALI, 599 HOLLOWAY ROAD, LONDON, N19 4DJ**

1. Synopsis

- 1.1 This is an application for a new premises licence under the Licensing Act 2003 made by Hiren Hasmukhbhai Patel.
- 1.2 The new application is to:
- Permit the premises to sell alcohol, on and off supplies, Monday to Saturday from 10:00 until 23:00 and Sunday from 10:00 until 22:00.
 - Permit the provision of late night refreshment, Monday to Saturday from 23:00 until 23:30.
 - Opening hours from 07:00 until 23:30 Monday to Saturday and from 07:00 until 22:30 on Sunday.

A copy of the application is attached as Appendix 1.

2. Relevant Representations

Licensing Authority	No
Metropolitan Police	No – Conditions agreed, see Appendix 3

Noise	No – Conditions agreed, see Appendix 3
Health and Safety	No
Trading Standards	No
Public Health	No
Safeguarding Children	No
London Fire Brigade	No
Local residents	Yes – One local resident
Other bodies	Yes – One Ward Councillor and a Residents Association

3. Background

3.1 Papers are attached as follows:-

- Appendix 1: application form;
- Appendix 2: representations;
- Appendix 3: suggested conditions and map of premises location.
- Appendix 4: email from Hilda Cameron, Consultant acting on behalf of the applicant
- Appendix 5: the decision of the Licensing Sub Committee on 29 April 2014.

3.2 The application is subject to three representations. These were from a Ward Councillor, a local resident and a Resident Association. Copies of the representations are attached as Appendix 2.

3.3 The Police and Islington's Noise Service have agreed conditions with the applicant. A copy of the agreed conditions is attached as Appendix 3.

3.4 On 21 May, Ms Hilda Cameron, the Licensing Consultant acting on behalf of the applicant, emailed the department to give more details of the proposed business and explain the reasons for applying. A copy of this email is attached as Appendix 4.

3.5 The premises are located within the Holloway and Finsbury Park Cumulative Impact Policy area, adopted by the Council on 24 January 2013.

3.6 The premises held an alcohol licence from November 2006, however the licence was reviewed by Trading Standards in July 2013, based on the licensing objectives of the prevention of crime and disorder and the protection of children from harm, following three underage sales at the premises within a 28 month period, the seizure of 24 bottles of illicit spirits and breaches of the premises licence conditions. Members of the Licensing Sub Committee revoked the premises on 10 September 2013. The hours for the sale by retail of alcohol for the previous premises licence were from 07:00 until midnight Monday to Sunday. The premises licence holder at this time was Nita Raikundalia.

3.7 An application was received for a new premises licence in March 2014, with application hours sought from 08:00 until 23:00 for the sale of alcohol off the premises only. The applicant at this time was Gagandeep Bedi. This application received representations from the Police and Islington's Noise Service and was therefore referred to a meeting of the Licensing Sub Committee for determination. Members of the Sub Committee heard the application on 29 April 2014 and decided to refuse the application. A copy of the decision is attached as Appendix 4.

4. Planning Implications

4.1 The Planning Service has reported that there are no restrictive conditions in force.

5 Recommendations

5.1 To determine the application for a new premises licence under Section 17 of the Licensing Act 2003.

5.2 If the Committee grants the application it should be subject to:

- i. conditions prepared by the Licensing Officer which are consistent with the Operating Schedule (see appendix 3)
- ii. any conditions deemed appropriate by the Committee to promote the four licensing objectives.(see appendix 3)
- iii. any conditions deemed necessary by the Committee to promote the four licensing objectives.

6 Conclusion and reasons for recommendations

6.1 The Council is required to consider this application in the light of all relevant information, and if approval is given, it may attach such conditions as appropriate to promote the licensing objectives.

Background papers:

The Council's Statement of Licensing Policy
Licensing Act 2003
Secretary of States Guidance

Final Report Clearance

Signed by

Janice Gibbons
Service Director – Public Protection

Date

3 July 2015

Received by

Head of Scrutiny and Democratic Services

Date

Report author: Licensing Service

Tel: 020 75027 3031

E-mail: licensing@islington.gov.uk

Application for a premises licence to be granted under the Licensing Act 2003

PLEASE READ THE FOLLOWING INSTRUCTIONS FIRST

Before completing this form please read the guidance notes at the end of the form. If you are completing this form by hand please write legibly in block capitals. In all cases ensure that your answers are inside the boxes and written in black ink. Use additional sheets if necessary.

You may wish to keep a copy of the completed form for your records.

I/We Hiren Hasmukhbhai Patel D.O.B 15/07/1988
(Insert name(s) of applicant)

apply for a premises licence under section 17 of the Licensing Act 2003 for the premises described in Part 1 below (the premises) and I/we are making this application to you as the relevant licensing authority in accordance with section 12 of the Licensing Act 2003

Part 1 – Premises Details

Postal address of premises or, if none, ordnance survey map reference or description			
Asian and Euro Dali (Currently HK Newsagents)			
599 Holloway Road			
Post town	London	Post code	N19 4DJ

Telephone number at premises (if any)	07535982893
Non-domestic rateable value of premises	£10750

Part 2 - Applicant Details

Please state whether you are applying for a premises licence as
Please tick yes

- a) an individual or individuals * please complete section (A)
- b) a person other than an individual *
 - i. as a limited company please complete section (B)
 - ii. as a partnership please complete section (B)
 - iii. as an unincorporated association or please complete section (B)
 - iv. other (for example a statutory corporation) please complete section (B)
- c) a recognised club please complete section (B)
- d) a charity please complete section (B)

- e) the proprietor of an educational establishment please complete section (B)
- f) a health service body please complete section (B)
- g) a person who is registered under Part 2 of the Care Standards Act 2000 (c14) in respect of an independent hospital please complete section (B)
- h) the chief officer of police of a police force in England and Wales please complete section (B)

* If you are applying as a person described in (a) or (b) please confirm:

Please tick yes

- I am carrying on or proposing to carry on a business which involves the use of the premises for licensable activities; or
- I am making the application pursuant to a
 - statutory function or
 - a function discharged by virtue of Her Majesty's prerogative

(A) INDIVIDUAL APPLICANTS (fill in as applicable)

Mr <input checked="" type="checkbox"/>	Mrs <input type="checkbox"/>	Miss <input type="checkbox"/>	Ms <input type="checkbox"/>	Other Title (for example, Rev)	
Surname Patel			First names Hiren Hasmukhbhai		
I am 18 years old or over				<input checked="" type="checkbox"/> Please tick yes	
Current postal address if different from premises address		[REDACTED]			
Post Town		[REDACTED]		Postcode	
Daytime contact telephone number		[REDACTED]			
E-mail address (optional)					

SECOND INDIVIDUAL APPLICANT (if applicable)

Mr <input type="checkbox"/>	Mrs <input type="checkbox"/>	Miss <input type="checkbox"/>	Ms <input type="checkbox"/>	Other Title (for example, Rev)	
Surname			First names		
I am 18 years old or over				<input type="checkbox"/> Please tick yes	

Current postal address if different from premises address			
Post Town		Postcode	
Daytime contact telephone number			
E-mail address (optional)			

(B) OTHER APPLICANTS

Please provide name and registered address of applicant in full. Where appropriate please give any registered number. In the case of a partnership or other joint venture (other than a body corporate), please give the name and address of each party concerned.

Name
Address
Registered number (where applicable)
Description of applicant (for example, partnership, company, unincorporated association etc.)
Telephone number (if any)
E-mail address (optional)

Part 3 Operating Schedule

When do you want the premises licence to start?

Day		Month		Year	

If you wish the licence to be valid only for a limited period, when do you want it to end?

Day		Month		Year	

Please give a general description of the premises (please read guidance note1)

A corner shop adjacent to parade of shops, facing a main road. Asian and Euro Dalii is a delicatessen specialising in local and European produce. The Deli will be based on the ground floor of 599 Holloway Road, Islington. The plan is to sell products such as cheese, olives, preserves, cakes, sandwiches and coffee. Also; to sell alcohol and beer of 6.5 ABV or lower with food for the consumption on and of the premises. Asian and Euro Dali intend to have some tables and chairs on the shop floor and on the shop front Fforecourt where customers can consume food and drink sold by Asian and Euro Dali. However: Alcohol sale shall end at 23:00 Monday-Saturday, 22:00 Sunday.

If 5,000 or more people are expected to attend the premises at any one time, please state the number expected to attend.

What licensable activities do you intend to carry on from the premises?

(Please see sections 1 and 14 of the Licensing Act 2003 and Schedules 1 and 2 to the Licensing Act 2003)

Provision of regulated entertainment

Please tick yes

- | | |
|---|-------------------------------------|
| a) plays (if ticking yes, fill in box A) | <input type="checkbox"/> |
| b) films (if ticking yes, fill in box B) | <input checked="" type="checkbox"/> |
| c) indoor sporting events (if ticking yes, fill in box C) | <input type="checkbox"/> |
| d) boxing or wrestling entertainment (if ticking yes, fill in box D) | <input type="checkbox"/> |
| e) live music (if ticking yes, fill in box E) | <input checked="" type="checkbox"/> |
| f) recorded music (if ticking yes, fill in box F) | <input checked="" type="checkbox"/> |
| g) performances of dance (if ticking yes, fill in box G) | <input checked="" type="checkbox"/> |
| h) anything of a similar description to that falling within (e), (f) or (g) (if ticking yes, fill in box H) | <input type="checkbox"/> |

Provision of entertainment facilities:

- | | |
|---|-------------------------------------|
| i) making music (if ticking yes, fill in box I) | <input checked="" type="checkbox"/> |
| j) dancing (if ticking yes, fill in box J) | <input checked="" type="checkbox"/> |
| k) entertainment of a similar description to that falling within (i) or (j) (if ticking yes, fill in box K) | <input type="checkbox"/> |

Provision of late night refreshment (if ticking yes, fill in box L)

Supply of alcohol (if ticking yes, fill in box M)

In all cases complete boxes N, O and P

A

Plays Standard days and timings (please read guidance note 6)			Will the performance of a play take place indoors or outdoors or both – please tick (please read guidance note 2)	Indoors	<input type="checkbox"/>
				Outdoors	<input type="checkbox"/>
				Both	<input type="checkbox"/>
Day	Start	Finish	Please give further details here (please read guidance note 3)		
Mon					
			State any seasonal variations for performing plays (please read guidance note 4)		
Tue					
			Non standard timings. Where you intend to use the premises for the performance of plays at different times to those listed in the column on the left, please list (please read guidance note 5)		
Wed					
Thur					
Fri					
Sat					
Sun					

B

Films Standard days and timings (please read guidance note 6)			Will the exhibition of films take place indoors or outdoors or both – please tick (please read guidance note 2)	Indoors	<input type="checkbox"/>
				Outdoors	<input type="checkbox"/>
				Both	<input type="checkbox"/>
Day	Start	Finish	Please give further details here (please read guidance note 3)		
Mon					
Tue			State any seasonal variations for the exhibition of films (please read guidance note 4)		
Wed					
Thur			Non standard timings. Where you intend to use the premises for the exhibition of films at different times to those listed in the column on the left, please list (please read guidance note 5)		
Fri					
Sat					
Sun					

C

Indoor sporting events Standard days and timings (please read guidance note 6)			<u>Please give further details</u> (please read guidance note 3)
Day	Start	Finish	
Mon			<u>State any seasonal variations for indoor sporting events</u> (please read guidance note 4)
Tue			
Wed			<u>Non standard timings. Where you intend to use the premises for indoor sporting events at different times to those listed in the column on the left, please list</u> (please read guidance note 5)
Thur			
Fri			
Sat			
Sun			

D

Boxing or wrestling entertainments Standard days and timings (please read guidance note 6)			Will the boxing or wrestling entertainment take place indoors or outdoors or both – please tick (please read guidance note 2)	Indoors	<input type="checkbox"/>
				Outdoors	<input type="checkbox"/>
				Both	<input type="checkbox"/>
Day	Start	Finish	Please give further details here (please read guidance note 3)		
Mon					
Tue					
Wed			State any seasonal variations for boxing or wrestling entertainment (please read guidance note 4)		
Thur					
			Non standard timings. Where you intend to use the premises for boxing or wrestling entertainment at different times to those listed in the column on the left, please list (please read guidance note 5)		
Fri					
Sat					
Sun					

E

Live music Standard days and timings (please read guidance note 6)			<u>Will the performance of live music take place indoors or outdoors or both – please tick</u> (please read guidance note 2)	Indoors <input type="checkbox"/>
				Outdoors <input type="checkbox"/>
				Both <input type="checkbox"/>
Day	Start	Finish		
Mon			<u>Please give further details here</u> (please read guidance note 3)	
Tue			<u>State any seasonal variations for the performance of live music</u> (please read guidance note 4)	
Wed			<u>Non standard timings. Where you intend to use the premises for the performance of live music at different times to those listed in the column on the left, please list</u> (please read guidance note 5)	
Thur				
Fri				
Sat				
Sun				

F

Recorded music Standard days and timings (please read guidance note 6)			<u>Will the playing of recorded music take place indoors or outdoors or both – please tick</u> (please read guidance note 2)	Indoors	<input type="checkbox"/>
				Outdoors	<input type="checkbox"/>
				Both	<input type="checkbox"/>
Day	Start	Finish	<u>Please give further details here</u> (please read guidance note 3)		
Mon					
Tue					
Wed			<u>State any seasonal variations for the playing of recorded music</u> (please read guidance note 4)		
Thur					
Fri			<u>Non standard timings. Where you intend to use the premises for the playing of recorded music at different times to those listed in the column on the left, please list</u> (please read guidance note 5)		
Sat					
Sun					

G

Performances of dance Standard days and timings (please read guidance note 6)			<u>Will the performance of dance take place indoors or outdoors or both – please tick</u> (please read guidance note 2)	Indoors <input type="checkbox"/>
				Outdoors <input type="checkbox"/>
				Both <input type="checkbox"/>
Day	Start	Finish	<u>Please give further details here</u> (please read guidance note 3)	
Mon				
Tue			<u>State any seasonal variations for the performance of dance</u> (please read guidance note 4)	
Wed				
Thur			<u>Non standard timings. Where you intend to use the premises for the performance of dance at different times to those listed in the column on the left, please list</u> (please read guidance note 5)	
Fri				
Sat				
Sun				

H

Anything of a similar description to that falling within (e), (f) or (g) Standard days and timings (please read guidance note 6)			<u>Please give a description of the type of entertainment you will be providing</u>		
Day	Start	Finish	<u>Will this entertainment take place indoors or outdoors or both – please tick</u> (please read guidance note 2)	Indoors	<input type="checkbox"/>
Mon				Outdoors	<input type="checkbox"/>
				Both	<input type="checkbox"/>
Tue			<u>Please give further details here</u> (please read guidance note 3)		
Wed					
Thur			<u>State any seasonal variations for entertainment of a similar description to that falling within (e), (f) or (g)</u> (please read guidance note 4)		
Fri					
Sat			<u>Non standard timings. Where you intend to use the premises for the entertainment of a similar description to that falling within (e), (f) or (g) at different times to those listed in the column on the left, please list</u> (please read guidance note 5)		
Sun					

I

Provision of facilities for making music Standard days and timings (please read guidance note 6)			<u>Please give a description of the facilities for making music you will be providing</u>	
			<u>Will the facilities for making music be indoors or outdoors or both – please tick</u> (please read guidance note 2)	
			Indoors	<input type="checkbox"/>
			Outdoors	<input type="checkbox"/>
			Both	<input type="checkbox"/>
Day	Start	Finish	<u>Please give further details here</u> (please read guidance note 3)	
Mon				
Tue				
Wed				
			<u>State any seasonal variations for the provision of facilities for making music</u> (please read guidance note 4)	
Thur			<u>Non standard timings. Where you intend to use the premises for provision of facilities for making music at different times to those listed in the column on the left, please list</u> (please read guidance note 5)	
Fri				
Sat				
Sun				

J

Provision of facilities for dancing Standard days and timings (please read guidance note 6)			Will the facilities for dancing be indoors or outdoors or both – please tick (see guidance note 2)		Indoors	<input type="checkbox"/>
					Outdoors	<input type="checkbox"/>
					Both	<input type="checkbox"/>
			Please give a description of the facilities for dancing you will be providing			
Day	Start	Finish	Please give further details here (please read guidance note 3)			
Mon						
Tue						
Wed						
Thur						
Fri						
Sat						
Sun			State any seasonal variations for providing dancing facilities (please read guidance note 4)			
			Non standard timings. Where you intend to use the premises for the provision of facilities for dancing entertainment at different times to those listed in the column on the left, please list (please read guidance note 5)			

K

Provision of facilities for entertainment of a similar description to that falling within i or j Standard days and timings (please read guidance note 6)			<u>Please give a description of the type of entertainment facility you will be providing</u>		
Day	Start	Finish	<u>Will the entertainment facility be indoors or outdoors or both – please tick</u> (please read guidance note 2)	Indoors	<input type="checkbox"/>
Mon				Outdoors	<input type="checkbox"/>
				Both	<input type="checkbox"/>
Tue			<u>Please give further details here</u> (please read guidance note 3)		
Wed					
Thur			<u>State any seasonal variations for the provision of facilities for entertainment of a similar description to that falling within i or j</u> (please read guidance note 4)		
Fri					
Sat			<u>Non standard timings. Where you intend to use the premises for the provision of facilities for entertainment of a similar description to that falling within i or j at different times to those listed in the column on the left, please list</u> (please read guidance note 5)		
Sun					

L

Late night refreshment Standard days and timings (please read guidance note 6)			Will the provision of late night refreshment take place indoors or outdoors or both – please tick (please read guidance note 2)	Indoors	<input checked="" type="checkbox"/>			
				Outdoors	<input type="checkbox"/>			
				Both	<input type="checkbox"/>			
Day	Start	Finish	<u>Please give further details here</u> (please read guidance note 3)					
Mon	23:00	23:30						
	HRS	HRS						
Tue	23:00	23:30						
	HRS	HRS						
Wed	23:00	23:30				<u>State any seasonal variations for the provision of late night refreshment</u> (please read guidance note 4)		
	HRS	HRS						
Thur	23:00	23:30						
	HRS	HRS						
Fri	23:00	23:30				<u>Non standard timings. Where you intend to use the premises for the provision of late night refreshment at different times, to those listed in the column on the left, please list</u> (please read guidance note 5)		
	HRS	HRS						
Sat	23:00	23:30						
	HRS	HRS						
Sun								
	HRS	HRS						

M

Supply of alcohol Standard days and timings (please read guidance note 6)			Will the supply of alcohol be for consumption (Please tick box) (please read guidance note 7)	On the premises	<input checked="" type="checkbox"/>
				Off the premises	<input checked="" type="checkbox"/>
				Both	<input type="checkbox"/>
Day	Start	Finish	State any seasonal variations for the supply of alcohol (please read guidance note 4)		
Mon	10:00	23:00			
	HRS	HRS			
Tue	10:00	23:00			
	HRS	HRS			
Wed	10:00	23:00			
	HRS	HRS			
Thur	10:00	23:00			
	HRS	HRS			
Fri	10:00	23:00			
	HRS	HRS			
Sat	10:00	23:00			
	HRS	HRS			
Sun	10:00	22:00			
	HRS	HRS			
			Non standard timings. Where you intend to use the premises for the supply of alcohol at different times to those listed in the column on the left, please list (please read guidance note 5)		

State the name and details of the individual whom you wish to specify on the licence as premises supervisor

Name Hiren Hasmukhbhai Patel
Address [Redacted]
[Redacted] (if known)
[Redacted] (if known)

N

Please highlight any adult entertainment or services, activities, other entertainment or matters ancillary to the use of the premises that may give rise to concern in respect of children (please read guidance note 8)

NONE

O

Hours premises are open to the public Standard days and timings (please read guidance note 6)			State any seasonal variations (please read guidance note 4)
Day	Start	Finish	
Mon	07:00	23:30	
	HRS	HRS	
Tue	07:00	23:30	
	HRS	HRS	
Wed	07:00	23:30	
	HRS	HRS	
Thur	07:00	23:30	
	HRS	HRS	
Fri	07:00	23:30	
	HRS	HRS	
Sat	07:00	23:30	
	HRS	HRS	
Sun	07:00	22:30	
	HRS	HRS	

Non standard timings. Where you intend the premises to be open to the public at different times from those listed in the column on the left, please list (please read guidance note 5)

P Describe the steps you intend to take to promote the four licensing objectives:

a) General – all four licensing objectives (b,c,d,e) (please read guidance note 9)

It will be ensured that all four licensing objectives will be promoted as detailed in each section below. When employees are hired, they will receive appropriate training followed by monthly refresher training to enable promotion of all four licensing objectives:

- Appropriate staff training in responsible alcohol retailing to be completed, training records shall be made available for inspection upon request by a relevant officer of a responsible authority.
- Challenge 25 policy will be implemented at the premises, acceptable forms of proof of age will be a passport, a photo card driving licence or pass accredited identification card.
- Refusal book shall be operated and maintained.
- CCTV operating 24 hours a day, the recording stored for 31 days and made available upon request by a relevant officer of a responsible authority.
- Joining neighbourhood schemes and liaising with the local police
- Staff will be given training on health and safety and food hygiene.
- Alcohol will only be purchased from an approved supplier and purchase receipt will be made available for inspection upon request by a relevant officer of a responsible authority.
- Alcohol will be served auxiliary to food
- Off sale alcohol will only be sold accompanied by food of the menu
- Beer sold shall not exceed 6.5 ABV
- No alcohol shall be sold after 23:00 Monday-Saturday, 22:00 Sunday and alcohol cabinets will be locked at 23:00 Monday-Saturday, 22:00 Sunday.
- Alcohol sale will end at 23:00 Monday-Saturday, 22:00 Sunday.

b) The prevention of crime and disorder

- CCTV operating 24 hours a day, the recording stored for 31 days and made available upon request by a relevant officer of a responsible authority.
- Joining neighbourhood schemes and liaising with the local police.
- Appropriate staff training in responsible alcohol retailing to be completed, training records shall be made available for inspection upon request by a relevant officer of a responsible authority.
- Highly visible sign outside the premises that shows opening hours under the terms of the premises license during which licensable activities are permitted.
- Clear signs stating that any theft or criminal behaviour will be reported to the police will be prominently displayed at the premises at all times and police will be contacted regarding any criminal activity.
- Adequate lighting provided inside and outside the premises.
- Excessive drinking will be discouraged and any promotions will not encourage irresponsible drinking.
- No serving of alcohol to persons who are intoxicated.
- A zero-tolerance policy will be implemented regarding the use of illegal drugs on the premises and all offenders will be reported to police, a notice shall be displayed at the premises.
- Keep clear view of the premises
- Liaise with the local police and joining neighbourhood schemes.
- Abide by the law

c) Public safety

- To comply with all current, fire and health and safety legislation as required by the law.
- Health and safety risk assessments to be carried out regularly
- All employees will receive training on health and safety & food safety
- Staff to be trained in fire evacuation procedures
- Fire exit signs shall be displayed, where it can be easily visible
- Installation of appropriate and adequate safety equipment
- Reliable taxi firm details will be displayed where it will be clearly visible to customers.

d) The prevention of public nuisance

- All staff shall be trained; training records shall be made available for inspection upon request by a relevant officer of a responsible authority.
- Notice to customers regarding consideration shall be displayed at the entrance and exit
- Deliveries of goods will be carried out at such a time or in such a manner as to prevent nuisance and disturbance to nearby businesses and residents.
- Staff who arrive early morning or depart late at night will be asked not to cause disturbance to nearby residents.
- Depositing of waste will be at times that minimise any nuisance to nearby neighbours.
- Strict policy not to serve drunken customers.
- Monitor anti-social behaviour through CCTV.
- Join retail watch schemes
- Dps contact details shall be clearly displayed for the public living with the vicinity
- All incidents shall be recorded in the incident book and shall be made available for inspection upon request by a relevant officer of a responsible authority.

e) The protection of children from harm

- Valid ID (UK driver's license or a passport) and all staff will be trained on how to tell whether the ID is authentic.
 - Alcohol will not be sold unless a valid ID document is produced in these cases. A sign explaining all this will be prominently displayed at the premises.
 - Appropriate staff training in responsible alcohol retailing to be completed, training records shall be made available for inspection upon request by a relevant officer of a responsible authority.
 - Challenge 25 to be implemented strictly, acceptable forms of proof of age will be a passport, a photo card driving licence or pass accredited identification card.
 - Refusal book shall be operated and maintained..
- Children to be accompanied by an adult when visiting the premises after 18:00

Please tick yes

- I have made or enclosed payment of the fee
- I have enclosed the plan of the premises
- I have sent copies of this application and the plan to responsible authorities and others where applicable
- I have enclosed the consent form completed by the individual I wish to be premises supervisor, if applicable
- I understand that I must now advertise my application
- I understand that if I do not comply with the above requirements my application will be rejected

IT IS AN OFFENCE, LIABLE ON CONVICTION TO A FINE UP TO LEVEL 5 ON THE STANDARD SCALE, UNDER SECTION 158 OF THE LICENSING ACT 2003 TO MAKE A FALSE STATEMENT IN OR IN CONNECTION WITH THIS APPLICATION

Part 4 – Signatures (please read guidance note 10)

Signature of applicant or applicant’s solicitor or other duly authorised agent (See guidance note 11). **If signing on behalf of the applicant please state in what capacity.**

Signature	
Date	20 May 2015
Capacity	Agent

For joint applications signature of 2nd applicant or 2nd applicant’s solicitor or other authorised agent. (please read guidance note 12). **If signing on behalf of the applicant please state in what capacity.**

Signature	
Date	
Capacity	

Contact name (where not previously given) and postal address for correspondence associated with this application (please read guidance note 13)

Hilda Cameron
 Licensing & Qualifications Ltd
 Westminster Business Centre
 Printing House Lane

Post town	Hayes	Post code	UB3 1AP
------------------	-------	------------------	---------

Telephone number (if any)	07502224452
----------------------------------	-------------

If you would prefer us to correspond with you by e-mail your e-mail address (optional)
 hilda@lqaa.co.uk

Notes for Guidance

1. Describe the premises. For example the type of premises, its general situation and layout and any other information which could be relevant to the licensing objectives. Where your application includes off-supplies of alcohol and you intend to provide a place for consumption of these off-supplies you must include a description of where the place will be and its proximity to the premises.
2. Where taking place in a building or other structure please tick as appropriate. Indoors may include a tent.
3. For example the type of activity to be authorised, if not already stated, and give relevant further details, for example (but not exclusively) whether or not music will be amplified or unamplified.
4. For example (but not exclusively), where the activity will occur on additional days during the summer months.
5. For example (but not exclusively), where you wish the activity to go on longer on a particular day e.g. Christmas Eve.
6. Please give timings in 24 hour clock (e.g. 16:00) and only give details for the days of the week when you intend the premises to be used for the activity.
7. If you wish people to be able to consume alcohol on the premises please tick on, if you wish people to be able to purchase alcohol to consume away from the premises please tick off. If you wish people to be able to do both please tick both.
8. Please give information about anything intended to occur at the premises or ancillary to the use of the premises which may give rise to concern in respect of children, regardless of whether you intend children to have access to the premises, for example (but not exclusively) nudity or semi-nudity, films for restricted age groups, the presence of gaming machines.
9. Please list here steps you will take to promote all four licensing objectives together.
10. The application form must be signed.
11. An applicant's agent (for example solicitor) may sign the form on their behalf provided that they have actual authority to do so.
12. Where there is more than one applicant, both applicants or their respective agents must sign the application form.
13. This is the address which we shall use to correspond with you about this application.

Consent of individual to being specified as premises supervisor

Hiren Hasmukhbhai Patel

I
[full name of prospective premises supervisor]

of

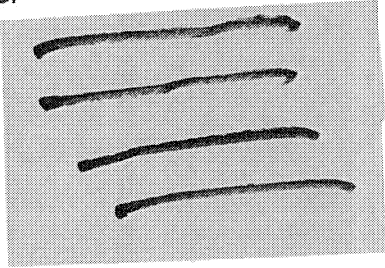

[home address of prospective premises supervisor]

hereby confirm that I give my consent to be specified as the designated premises supervisor in relation to the application for

New Premises Application

[type of application]

by

Hiren Hasmukhbhai Patel

[name of applicant]

relating to a premises licence

N/A

[number of existing licence, if any]

for

**Asian and Euro Dali (Currently called HK Newsagents)
599 Holloway Road
London
N19 4DJ**

[name and address of premises to which the application relates]

and any premises licence to be granted or varied in respect of this application made by

Hiren Hasmukhbhai Patel

[name of applicant]

concerning the supply of alcohol at

**599 Holloway Road
London
N19 4DJ**

[name and address of premises to which application relates]

I also confirm that I am applying for, intend to apply for or currently hold a personal licence, details of which I set out below.

Personal licence number

Applied for

[insert personal licence number, if any]

Personal licence issuing authority

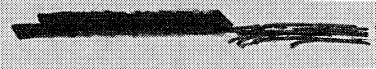

[insert name and address and telephone number of personal licence issuing authority, if any]

Signed

*Patel
Hiren
H.*

Name (please print)

Hiren Hasmukhbhai Patel

Date

10 May 2015

PROPOSED LICENSING PLAN

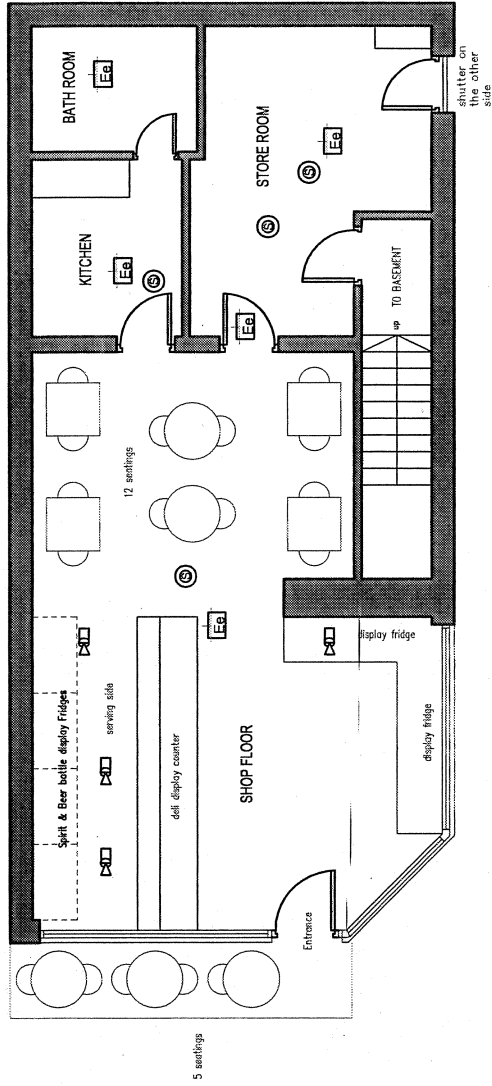

SCALE 1:100

Paper Size A4

	FIRE EXTINGUISHERS
	EMERGENCY LIGHTS
	C C TV CAMERA
	FIRE EXIT SIGN
	SMOKE/HEAT DETECTOR
	SWITCH BOARD
	POWER POINT
	GAS EMG STOP

CCTV RECORDINGS: _____

SHUTTERS PROVIDED: YES _____ NO _____

ALARM SYSTEM TO AOI SPEC OR SIMILAR FITTED

PREMISES NAME & ADDRESS:

From: [REDACTED]
Sent: 18 June 2015 12:24
To: Planning
Subject: Your ref: WK/201585871; 599 Holloway Road, N19

I am writing to support residents who have objected to an application for an alcohol licence and late night refreshment licence at 599 Holloway Road.

1. Cumulative Impact Area

This area is a Cumulative Impact Area, so another outlet is not needed. There is already more than adequate provision of premises selling alcoholic beverages on both sides of Holloway Road from the Odeon cinema to Archway Tube station. Between Wedmore Street and Archway, there are already several grocery shops that sell alcohol, including Sainsbury and Tesco.

2. Public nuisance

Wedmore Gardens is a residential street and residents are concerned that the provision of hot food and alcohol late at night will attract consumers who may well congregate outside the shop and in Wedmore Gardens, producing noise and litter. Already beer cans are left in the alley behind the shop at no. 599 (although it does not at present have a licence to sell alcohol).

3. Crime and disorder

The provision of hot food and alcohol late at night is likely to provide a focus for groups to congregate as they consume whatever they have bought. Residents are concerned that customers would hang around in Wedmore Gardens itself. This will in turn lead to possibilities for generating crime and disorder.

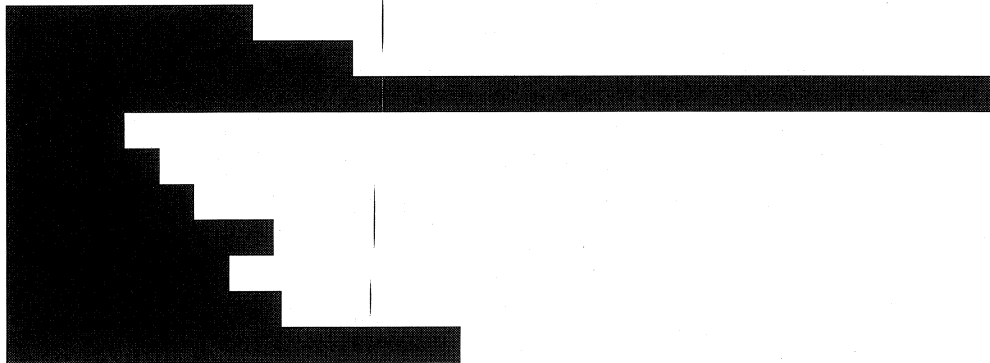

From: [REDACTED]
Sent: 17 June 2015 11:30
To: Licensing
Subject: Objection to premises licence application

Objection to premises licence application for Asian and Euro Deli, 599 Holloway Road, Islington, London.

Your ref: WK/201585871

Attention Anthony Baptiste, Licensing Service. Date: 17 June 2015

We are residents of [REDACTED], a residential street that runs off Holloway Road. The shop seeking the licence is located on the corner of this road.

In response to the application for a licence to sell alcohol and supply late-night refreshment at the above premises, we would like to make the following comments:

1. Cumulative Impact Area

As this area is already designated a Cumulative Impact Area, we suggest Islington Council should not be inclined to allow an application for an alcohol licence and a late night refreshment licence in a shop in this location.

There is already more than adequate provision of premises selling alcoholic beverages on both sides of Holloway Road from the Odeon cinema to Archway Tube station. Between Wedmore Street and Archway, there are already several grocery shops that sell alcohol, not to mention Sainsbury's convenience store which is open until late, and doubtless the forthcoming Tesco's will do the same. Adding another is unjustifiable.

If the shop claims not to be viable without the alcohol licence, then we would argue it has no rationale for being open at all, considering the significant late-opening provision that already exists along this stretch of the Holloway Road.

2. Public nuisance

[REDACTED] is a residential street doing its best to be a quiet one for its residents, who are mainly older people and couples with young children. Neither of these groups is likely to want to take advantage of late-night alcohol or food provision.

The provision of hot food and alcohol late at night will attract consumers who may well congregate outside the shop and in Wedmore Gardens, producing noise and litter.

Those who will take advantage of this facility are the people who already leave beer cans in the alley-way behind the shop at no. 599, though we note this squalid little area had lately (just last week) been cleared of its stash of crushed cans, perhaps in relation to this licence application. Also, it's not been encouraging to have seen cans of alcohol dumped in this location when the shop next to it does not yet have a licence to sell alcohol.

This street is already bedevilled with rubbish at the Holloway Road end, principally courtesy of the minicab drivers who trade out of this street, eat food in their cars and just toss it into the gutter, despite there being a rubbish bin a few yards away in front of the shop at no. 599. This nuisance has proved intractable to challenge, and we have no desire to see the rubbish factor increased by the provision of hot food to encourage further street eating and littering, whether by those driving the minicabs or those waiting to use one.

We see no reason why we as residents should have to encounter the increased mess this licence extension is likely to generate. As stated above, many of the street's residents are couples with young children, who have to walk them past this corner to their local school every day. If, in addition to the existing rubbish factor, there would be even more

litter and possibly vomit as a morning greeting to the young people of Islington, we couldn't interpret this as a social benefit to the locality.

3. Crime and disorder

The provision of hot food and alcohol late at night is likely to provide a focus for groups to congregate as they consume whatever they have bought. They may well hang around in [REDACTED] itself. This will in turn lead to possibilities for generating crime and disorder.

[REDACTED]

From: [REDACTED]
Sent: 12 June 2015 12:22
To: [REDACTED]
Cc: [REDACTED]
Subject: RE: Premises Licence Application: Asian and Euro Deli, 599 Holloway Road

Thank you for this notification. I am responding to this on behalf of the [REDACTED].

There has been considerable concern among residents regarding the number of off licences in the area, along with support for a reduction in their number. This was most recently confirmed by responses to the Neighbourhood Forum drop-in consultation event in March.

While residents do not oppose licences being issued for restaurant use, or for specialist off licence premises, there is much more concern about licences being issued to generalist businesses such as this one. Given the current level of competition among such premises, an operation without any specific draw or specialism will struggle to survive, and that is when the temptation arises to ignore the requirements of the licensing legislation.

In addition the current application for part shop, part restaurant, operating until late at night. This would effectively offer a day-long pub operation in shop premises and that would not be welcome. There are pub premises for such purposes and residents are keen to see those uses retained on those sites, rather than transferred to less appropriate locations such as this one.

Accordingly we would ask that the application be refused.

Regards,

[REDACTED]

Suggested conditions of approval consistent with the operating schedule

1. Staff at the premises shall receive appropriate training in responsible alcohol retailing to enable the promotion of all four licensing objectives. Refresher training shall be provided monthly to staff.
2. Training records shall be kept and will be made available for inspection upon request by a relevant officer of a Responsible Authority.
3. A member of staff at the premises shall subscribe to and participate fully in the local shop watch or any similar scheme.
4. Alcohol shall only be purchased from an approved supplier. The purchase receipt will be made available for inspection upon request by a relevant officer of a Responsible Authority.
5. On sales of alcohol shall be served ancillary to food.
6. Off sales of alcohol shall only be sold with food purchased from the menu.
7. No beer exceeding 6.5 ABV shall be sold at the premises.
8. CCTV shall be installed, operated and maintained in agreement with the Police. The system will enable frontal identification of every person entering the premises. The system shall record in real time and operate whilst the premises are open for licensable activities. The recordings shall be kept available for a minimum of 31 days. Recordings shall be made available to an Authorised Officer or a Police Officer (subject to the Data Protection Act 1998) within 24 hours of any request.
9. All instances of crime and disorder shall be reported to the police. Clear and prominent notices shall be displayed at the premises advising customers of this policy.
10. The licensee shall adopt the Challenge 25 and the BII National Standards Proof of Age Scheme.
11. The licensee shall ensure that staff are trained about age restricted products and ensure that they sign to confirm that they have understood the training. The licensee shall keep records of training and instruction given to staff.
12. In the absence of adequate daylight, the lighting in any area accessible to the public shall be fully in operation when they are present.
13. Excessive drinking will be discouraged and the premises shall not hold any promotions to encourage irresponsible drinking.
14. Alcohol shall not be sold to persons who are intoxicated.
15. A zero tolerance policy shall be implemented regarding the use of illegal drugs at the premises. All offenders shall be reported to the Police. A sign shall be displayed at the premises
16. To comply with all current fire, and health and safety legislation.
17. Health and Safety risk assessments shall be carried out regularly.
18. Fire exit signs shall be displayed where they are easily visible.
19. Appropriate and adequate safety equipment shall be installed at the premises and regularly maintained.

20. A dedicated licensed taxi/mini cab service shall be available with the premises for customers.
21. A notice shall be displayed at the entrances and exits of the premises asking customers not to cause a nuisance to neighbouring properties.
22. Staff arriving at the premises early in the morning, or leaving the premises late at night shall be asked not to cause a nuisance to neighbouring properties.
23. Waste from the premises shall be deposited at time which will not cause a nuisance to neighbouring properties.
24. The premises shall not sell alcohol to customers who are intoxicated.
25. The contact telephone number for the premises licence holder/designated premises supervisor/duty manager shall be displayed inside the premises or immediately outside the premises such that it is clearly visible from outside without the need to enter the premises.
26. An incident book shall be used to record all instances of public disorder. The incident log shall be made available upon request by a relevant officer of a Responsible Authority.
27. The licensee shall adopt the Challenge 25 and the BII National Standards Proof of Age Scheme
28. The licensee shall ensure that staff are trained about age restricted products and ensure that they sign to confirm that they have understood the training. The licensee shall keep records of training and instruction given to staff.
29. The licensee and staff should note any refusals to sell to young people in a refusals log. The refusals log shall be checked and signed monthly by the designated premises supervisor. The refusals log shall be made available for inspection by the licensing team, police or trading standards.

Suggested conditions of approval recommended by the Police - Agreed

1. CCTV shall be installed, operated and maintained in agreement with the Police. Maintained means that the system will be regularly serviced (at least once a year) and checked every two weeks to ensure that it is storing images correctly and a log kept and signed by a Supervisor to this effect. The system will provide an identifiable full head and shoulder image of everyone entering the premises and will operate in any light conditions within the premises. The system will cover the full exterior of the premises and shall record in real time, date and time stamped and will operate whilst the premises is open for licensable activities. The recordings will be kept for a minimum of 31 days and copies will be made available to an Authorised Officer or a Police Officer (subject to the Data Protection Act 1998) within 24hrs of any request free of charge. There will always be a member of staff on duty who can operate the system, to allow Officers to view recordings and if required by a Police Officer, provide a copy of images immediately free of charge to assist in the immediate investigation of offences. If the system malfunctions and will not be operating for longer than one day of business, then the Police must be informed.
2. The supply of alcohol on the premises shall only be to a person seated taking a table meal there and for consumption by such a person as ancillary to their meal.
3. Sales of alcohol for consumption off the premises shall only be supplied with, and ancillary to a take away meal.

Suggested conditions of approval recommended by the Noise Team - Agreed

1. No rubbish including will be moved, removed or placed in outside areas on Sundays or Bank Holidays, and between the hours of 23:00 and 07:00 hours other days of the week.
2. No deliveries will take place on Sundays or Bank Holidays, and between the hours of 23:00 and 07:00 hours other days of the week.

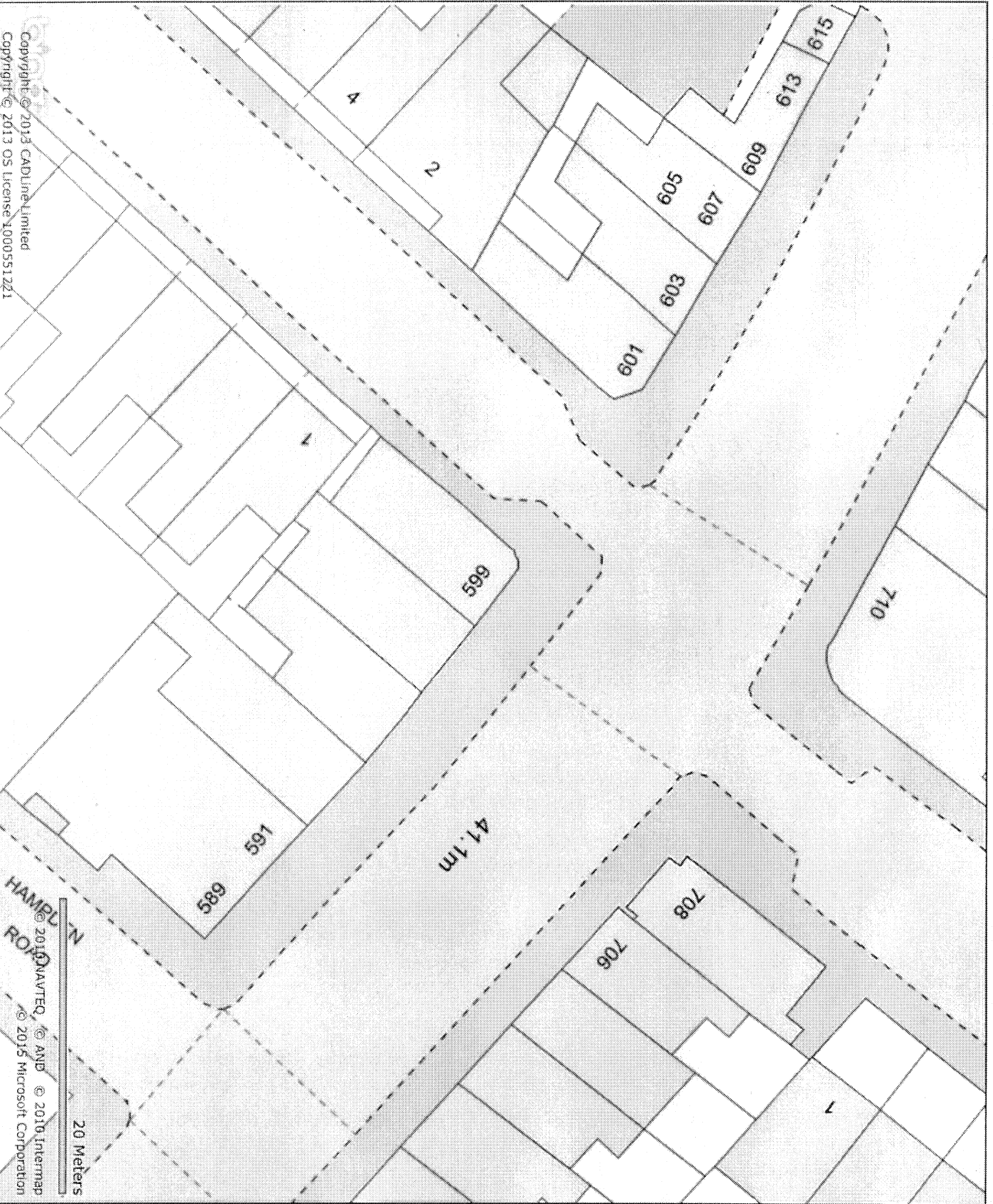

Copyright © 2013 CADLINE Limited
 Copyright © 2013 OS License 1000551221

HAMPDEN ROAD
 © 2013 ORANATEQ © AND © 2010 Intermap
 © 2015 Microsoft Corporation
 20 Meters

**Title : Asian and Euro
 Dali**

Islington Borough
 Boundary

Printed by :
 RO RO

Printed at :
 03-07-2015

Fitzsimons, Aiden

From: Hilda Cameron <hilda@lqaa.co.uk>
Sent: 21 May 2015 12:15
To: Licensing
Subject: Re: New Premises Application (599 Holloway Road)

Dear Sir/Madam

We have written this letter to give more details about the proposed delicatessen business and to explain the reasons for applying for a premises license and to alleviate any concerns that it might contribute to disorder or public nuisance in the vicinity.

Asian and Euro Dali is an independent food business that will sell high-quality produce from Asia and Europe.

The business idea behind the delicatessen is to transform the negative history of the premises to a pleasant and much more needed trade. Products will include Asian and European snacks, olives, chocolate, preserves and homemade cakes, coffee. License permitting, we'd also like to sell Asian and European produced wines and 6.5 or lower ABV beers. Asian and Euro Dali business model is not an off-licence or a drinking establishment and our aim is to provide specialist products sold at low volumes to complement our main business streams of Asian and European food. The primary model for the sale of alcohol at the premises is for customers to take home to consume or for consumption at the premises only as a complimentary with an item from the menu. Off sale alcohol will only be sold accompanied by food of the menu. The Delicatessen is small and only around 10-15 people can be seated at any time. The delicatessen is open to the public between 07:00-23:30 Monday-Saturday and 07:00- 22:30 Sunday, but alcohol will only be served between 10:00 and 23:00 Monday-Saturday and 10:00- 22:00 Sunday.

The four licensing objectives will be promoted and a strict challenge 25 policy will be implemented. Any persons attending the premises will be asked to leave the area quietly and without causing a nuisance. To aid both the police and council in their work of prevention of crime and disorder, the premises will have a CCTV system.

Please let me know if you require any further information or clarification, I'd be more than happy to discuss.

Yours sincerely,

Ms Hilda Cameron
Licensing Consultant

Mobile: 0750222 4452
Landline: 0208 1234 690
Email: info@lqaa.co.uk
Website: www.lqaa.co.uk



ISLINGTON COUNCIL LICENSING SUB-COMMITTEE
DECISION FORM

Licensing Sub-Committee D – 29 April 2014

Sunny Brothers Ltd, 599 Holloway Road, N19 4DJ

DECISION

The Sub-Committee have decided to refuse the application for a new premises licence in respect of **Sunny Brothers Ltd, 599 Holloway Rd, N19 4DJ**

The determination of the sub-committee (including the reasons for the decision) will be provided to you in writing within 5 working days.

REASONS FOR DECISION

The Sub-Committee listened to all the evidence and submissions and read all the material. The Sub-Committee reached the decision having given consideration to the Licensing Act 2003, as amended, and its regulations, the national guidance and the Council's Licensing Policy.

The Sub-Committee took into consideration Licensing Policy 002. The premises fall under the Holloway and Finsbury Park cumulative impact area. Licensing policy 002 creates a rebuttable presumption that applications for new premises licences that are likely to add to the existing cumulative impact will normally be refused, unless an applicant can demonstrate why the operation of the premises involved will not add to the cumulative impact or otherwise impact adversely on the promotion of the licensing objectives.

The Sub-Committee noted that the suggested conditions put forward by the police had been accepted but that the police objection remained on the basis of the cumulative impact zone. The Sub-Committee noted that whilst Trading Standards had not submitted a formal representation, in discussions with the applicant conditions had been suggested and agreed.

The Sub-Committee heard evidence that the applicant had worked for five years in off licences, had a degree in business studies and proposed to be a hands-on manager. The premises would be family run. The Sub-Committee noted that the applicant was not yet a member of any local organisations such as Pub Watch but that he was happy to become a member in the event of a licence being granted. The Sub-Committee heard evidence that the applicant intended to concentrate on the sale of high class wines and have less emphasis on strong cider or lager which could attract street drinkers, and took this information into consideration along with all other relevant material when reaching the decision.

The Sub-Committee noted that there were 42 licenses premises within a 500m radius of the premises, 17 of which were off-licences. The Sub-Committee noted that even with agreed conditions the police were still concerned about the cumulative impact of further licensed premises in this area, as was the pollution team.

The Sub-Committee concluded that a further off licence in the area would increase footfall and would add to the availability of alcohol in an area where there is already a large number of licensed premises with associated anti-social and criminal behaviour and therefore have a cumulative impact on the licensing objectives. In accordance with licensing policy 002, the Sub-Committee was satisfied that the grant of the application would undermine the licensing objectives. The applicant failed to rebut the presumption that the application if granted, would add to the cumulative impact area. The applicant did not show any exceptional circumstances as to why the Sub-Committee should grant the application.